

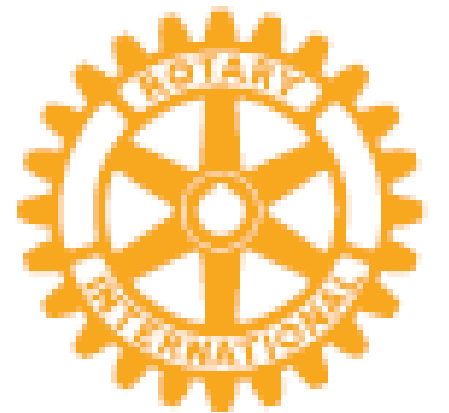

North Kitsap United

Kingston-NK  
**Rotary**  
Club



# Past Rotary Projects:

\*Kingston HS Lights

\*Heritage Park Trail Markers

\*Kingston Coffee Oasis

\*Village Green Community Center

\*Village Green Picnic Pavilion

\*Kingston Electronic Readerboard

Kingston-NK  
**Rotary**  
Club

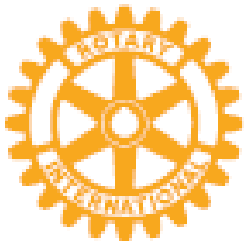

# Next Project?

## A Sports & Multigenerational Recreation Complex

Kingston-NK  
**Rotary**  
Club



# Community Service

- Homeless House Building Facility for 304 Kids
- Part of Success of Oasis Coffee
- Emergencies Prep - Plan/Spoken
- Received 5 Grants from From District
- Hands-on/Daily Assistance for others in Need - (Yard care/Ramps - chores)
- Kirk #2/Yard club - is leader for Regional Project
- Establish Athletic Complex (Unify all teams together)
- Sport ~~scholarship~~ 5K/15-20 Families
- ↑ Supporting the Art 5 (Kostind 6th Arts - in School)
- Bleacher Expansion

**Rotary Brainstorming Meeting**  
**May 12, 2018**

## Kitsap County Sports Field Complex - Heritage Park Drawing - May 2003

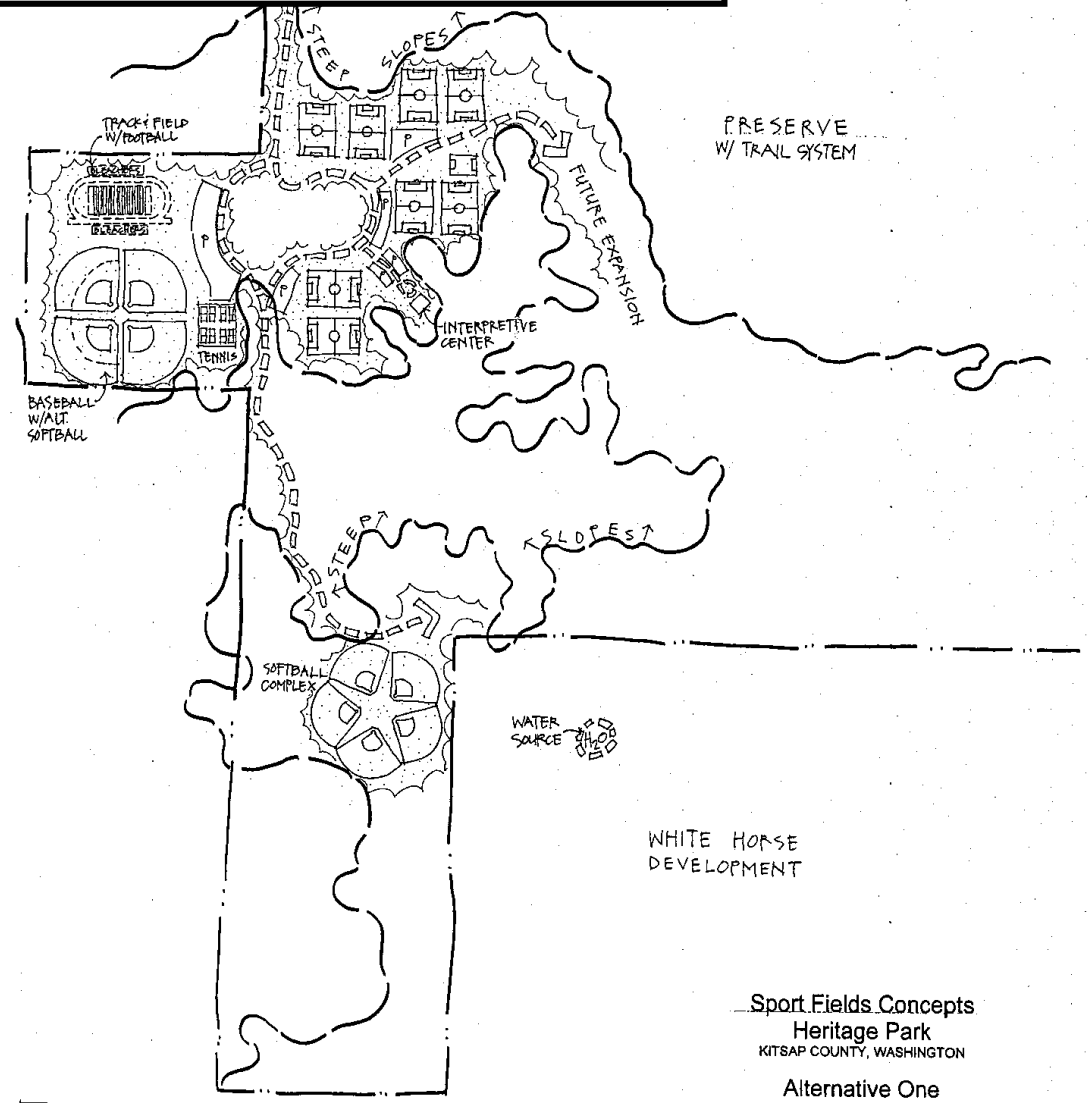

Sport Fields Concepts  
Heritage Park  
KITSAP COUNTY, WASHINGTON  
Alternative One

# Why this? Why Now?

Kingston-NK  
**Rotary**  
Club

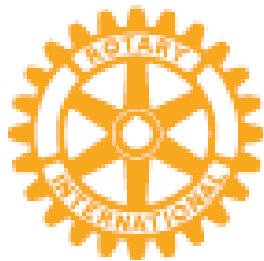

# Field Analysis:

<b>FIELDS:</b>	<b>NUMBER:</b>	<b>PLAYING SHAPE (1 (poor) to 5 (great)):</b>
Buck Lake Park	2 or 3 field space (soccer) + Playground Structure 2-Beach Volleyball Court	2
Gordon Elementary	1-Baseball + 1-field space	1
<u>Breidablik Elementary</u>	1-Baseball & Playground Structure	3
Indianola Orca Field	1-Baseball + 1 field space & Playground Structure	2
Kola Kole Park	1-Baseball + 1 field space	2
Kington Middle School	2-Baseball + 2 field space & Track, Football	1
Kingston High School	1-Baseball, 1-Softball & 1-Track, 1-Turf Football	2
North Kitsap High School	1-Outdoor Basketball, 2-Tennis/Pickleball Courts (Tennis/Turf/Track – 4 or 5) 4-Baseball/Softball + 3 field space & Track, Turf Football 6-Tennis/Pickleball Courts	4
Pearson Elementary	1-Baseball + 1 field space + Playground Structure	3
S'Klallam Tribe Fields	1-Baseball + 1 field space + Playground Structure 1-Indoor Basketball Court	4
Poulsbo Elementary	1-Baseball + 1 field space + Playground Structure	3
Poulsbo Middle School	3-Baseball + 2 field space & Track, Football	1
Snider Park (Little League)	6-Baseball (All Tournament Play Eligible)	4
Suquamish Elementary	1-Baseball plus field space (+1)	
Suquamish Community	1-Baseball + Outdoor Basketball Court	3
Strawberry Field	3 or 4 field space (soccer), 1-Turf Soccer/Football	3 or 4
Vinland Elementary	3 or 4 field space (soccer) + Playground Structure	3
<u>Wolfe Elementary</u>	2 or 3 field space (soccer) + Playground Structure	2 or 3
Village Green Community	Playground, Half Indoor Basketball, 2-Tennis/Pickleball	4.5





# 2023 Field Conditions







THE FOLLOWING ARE  
STRICTLY PROHIBITED  
SMOKING - ALCOHOL  
HITTING - GAMING  
RECYCLED WASTE AS  
HALLMARKET BEVERAGES





# 2023 Field Conditions















### SPRING 2023 BASEBALL CURRENT NEEDS:

78-teams x 2-practices/week x 1.5 - 2 hour practices = 312

78-teams x 1-game/week x 2-hours per game = 78

**390 hr/wk**

### AVAILABLE FIELD SPACE:

18-available practice fields x 3-hours/weekday x 5-days/week = 270

6-game day fields x 5-games/field x 2-weekend days/week = 60

**330 hr/wk**



# NKSD School Bond Vote:

\*Bond Measure (February) - \$0.10 per \$1,000 assessed... ~\$242M

\*Turfed & Lighted Baseball & Softball Fields at KHS & NKHS

\*New grandstands w/ cover for KHS Track & Football Field, restrooms, concessions & ticketing area

\*Sizable upgrades at both Kingston/Poulsbo Middle Schools

\*New Wolfle Elementary & Pearson Elementary, New Buildings at Gordon Elementary & Poulsbo Elementary

-Upper Field Drainage redo at Gordon (complete)



# Rotary Involvement:

- \*Volunteer Time on Field Work & Improvements
- \*YTD Donations to Local Sports/Rec Organizations over \$10k
- \*Community Services Committee Reviewing a \$5k Grant Application from KHS Baseball/Softball - Field Needs
- \*Fun Run Partnership w/ KHS Athletics Boosters (September?)
- \*Gathering Data - Working w/ County - Fundraising for Future

# Sports Summit Meeting:

\*September 15th - 25-people, 15-NK sports/rec organizations

## KEY TAKEAWAYS (AMONG OTHERS):

\*Central location, cut down distance families travel to activities

\*Need more turf and lighted fields - biggest need Spring/Fall

\*Need more indoor court space

\*Too many teams sharing field space (soccer - three teams on one field)

\*10%+ growth YOY in nearly every youth sport activity

# Sports Summit Meeting:

## KEY TAKEAWAYS:

- \*Nearly 80% of field space owned by North Kitsap School District
- \*Costs to use are too high - supply/demand compounds issue
- \*Who you know and priorities given to some for usage & priority
- \*NK Soccer - 560-kids (93% YOY increase)
- \*Peninsula Flag Football League - 4-conferences (NK, CK, SK, N. Mason)  
nearly 1,000-kids participating (fall season)

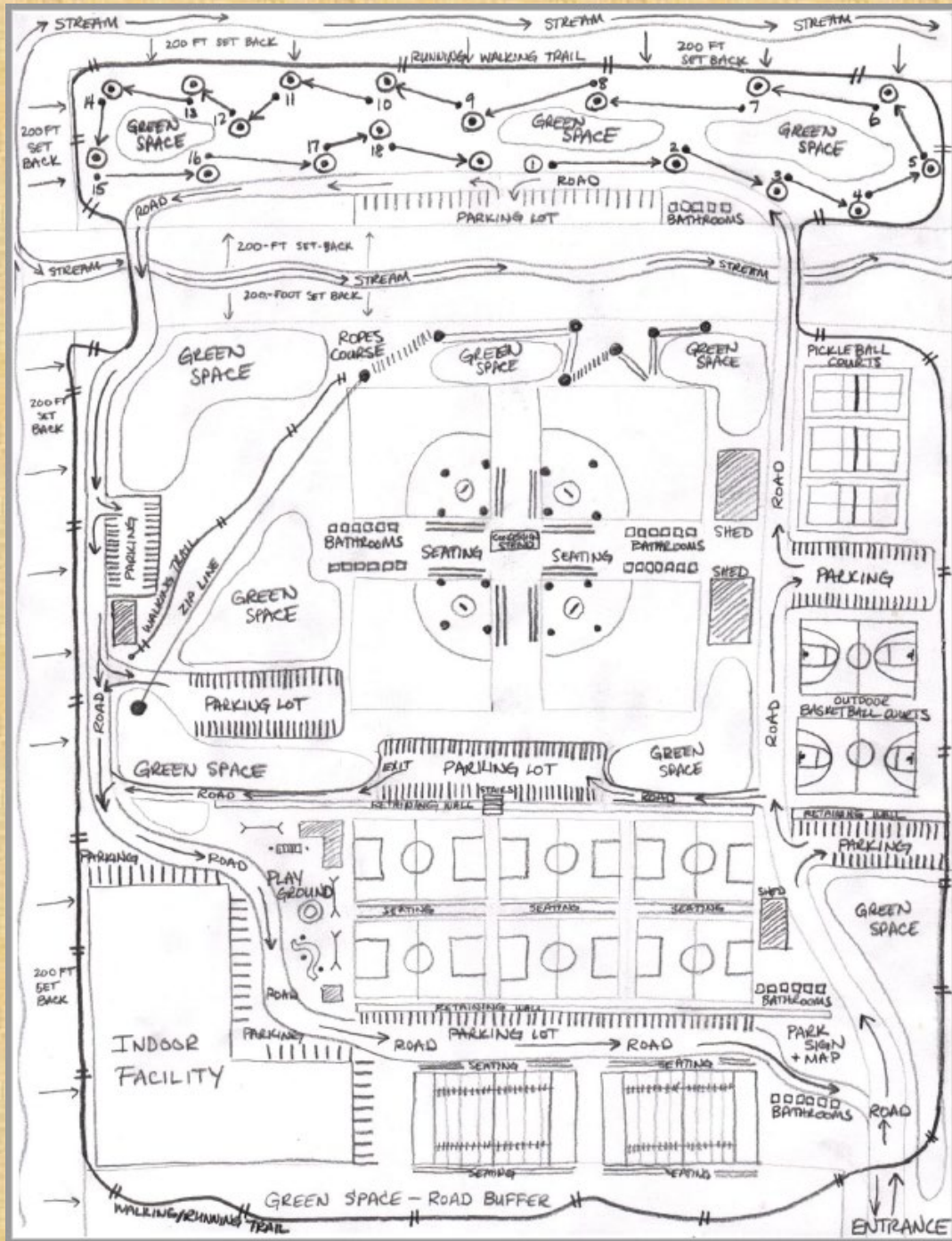

## ORIGINAL VISION:

- Multi-Use (Sports & Recreation)
- Multi-Generational (Use for All Ages)
- Outdoor Facilities (Prefer Turf w/ Lights)
- Indoor Facility - Use Year-Round
- Baseball/Softball, (Flag) Football, Soccer, Lacrosse, Basketball, Pickleball, Volleyball, Tennis, etc.
- Other Recreational Options – Frisbee Golf Course, Ropes Course, Zip Line, Walking/Jogging Trails, Playground, etc.
- Use for Business Development, Birthday Parties, Activities for Families/Kids, etc.
- Get Ahead of Growth & Current Issues



# CONCEPTUAL PLAN



## LEGEND

- 1 MAIN PEDESTRIAN WALKWAY
- 2 SNACK SHACK/SEATING AREA
- 3 RESTROOMS
- 4 CHILDREN'S PLAYGROUND
- 5 STORAGE BUILDINGS
- 6 PICNIC TABLES / FLEX AREA
- 7 LAWN GAMES  
IE. CORNHOLE  
BOCCE  
PING PONG

## TYPICAL SPORT FIELDS AND COURT SIZES

- LITTLE LEAGUE BASEBALL - 200' HOME PLATE TO FENCE
- JUNIOR/HIGH SCHOOL BASKETBALL - 56'x90'
- PICKLEBALL - 30' x 64'
- 9v9 SOCCER FIELD - 135' x 210'
- VOLLEYBALL - 48' x 78'

Kingston-NK  
**Rotary**  
Club





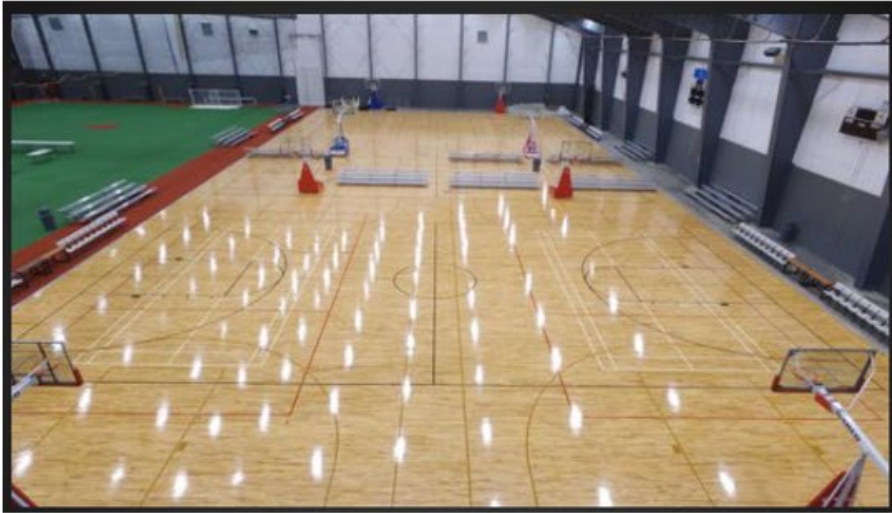

## Example - Centralia:

\* Build in 2010

\* 75,000-sq ft

\* Partnership between Lewis County Facility District, City of Centralia, Centralia School District & Private Organization (NW Sports Hub LLC.)

\* Inside a large sports complex

\* Mezzanine Seating, Concessions and Retail Space Inside



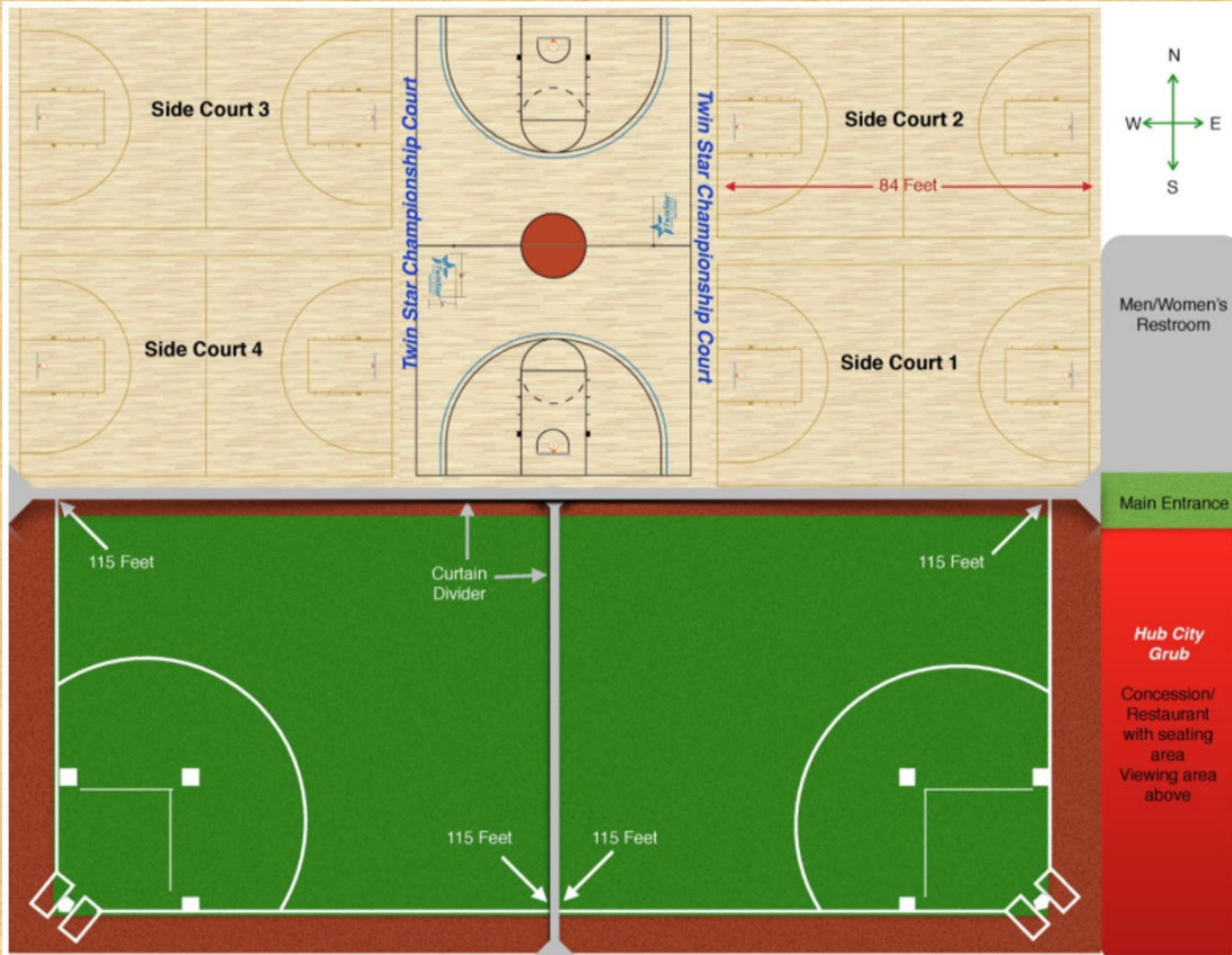

## Indoor Facility:

\*Hardwood Courts – multi-use (Basketball, Volleyball, Pickleball, Practice Space, etc.)

\*Turf field – multi-use (Baseball, Soccer, (Flag) Football, Practice Space, etc.)



# CONCEPTUAL PLAN



**ORIGINAL VISION NOW  
BIGGER, BETTER BECAUSE OF  
THIS RAYDIENT LAND  
OPPORTUNITY!**

**WHAT ELSE ADD TO MIX?**

- Pickleball
- Splash Park
- Ice Skate Rink
- Dog Park
- Outdoor Laser Tag
- Pool
- Arts/Theatre Center

What do you think?



## LEGEND

- 1 MAIN PEDESTRIAN WALKWAY
- 2 SNACK SHACK/SEATING AREA
- 3 RESTROOMS
- 4 CHILDREN'S PLAYGROUND
- 5 STORAGE BUILDINGS
- 6 PICNIC TABLES / FLEX AREA
- 7 LAWN GAMES  
IE. CORNHOLE  
BOCCE  
PING PONG

## TYPICAL SPORT FIELDS AND COURT SIZES

- LITTLE LEAGUE BASEBALL - 200' HOME PLATE TO FENCE
- JUNIOR/HIGH SCHOOL BASKETBALL - 56'x90'
- PICKLEBALL - 30' x 64'
- 9v9 SOCCER FIELD - 135' x 210'
- VOLLEYBALL - 48' x 78'

# Challenges We Face:

- \*Social Media Rumors and Mistruths
- \*Environment & Traffic Concerns
- \*Concerns on Water & Aquifer Recharge
- \*GMA/UGA Compliance & Land Use

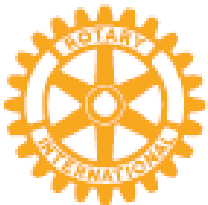



# North Kitsap United

## **Compliance with Kitsap County Land-Use Regulations and The Washington State Growth Management Act**

Kingston-NK  
**Rotary**  
Club



Summary of Elements, Zones, and Allowed Uses			
Element	Rural Wooded (current zoning)	Rural Residential	Rural Commercial
1. Sports and Recreation	P if non-commercial C if commercial	P if non-commercial ACUP if commercial	
2. YMCA	P if non-commercial C if commercial	P if non-commercial C if commercial	
3. Open Space	P	P	
4. Commercial	X	X	P
5. Residential Density 1 residential lot per 5 acres	X	P PBD if clustered	

**NKU: 100% GMA Compliance**

Key	
P	Permitted outright in the zone
C	Permitted with conditional use permit
ACUP	Permitted with administrative conditional use
X	Not permitted
PBD	Performance Based Design



# Exhibit A

## Percentage of Rural Lands by Comprehensive Plan Designation

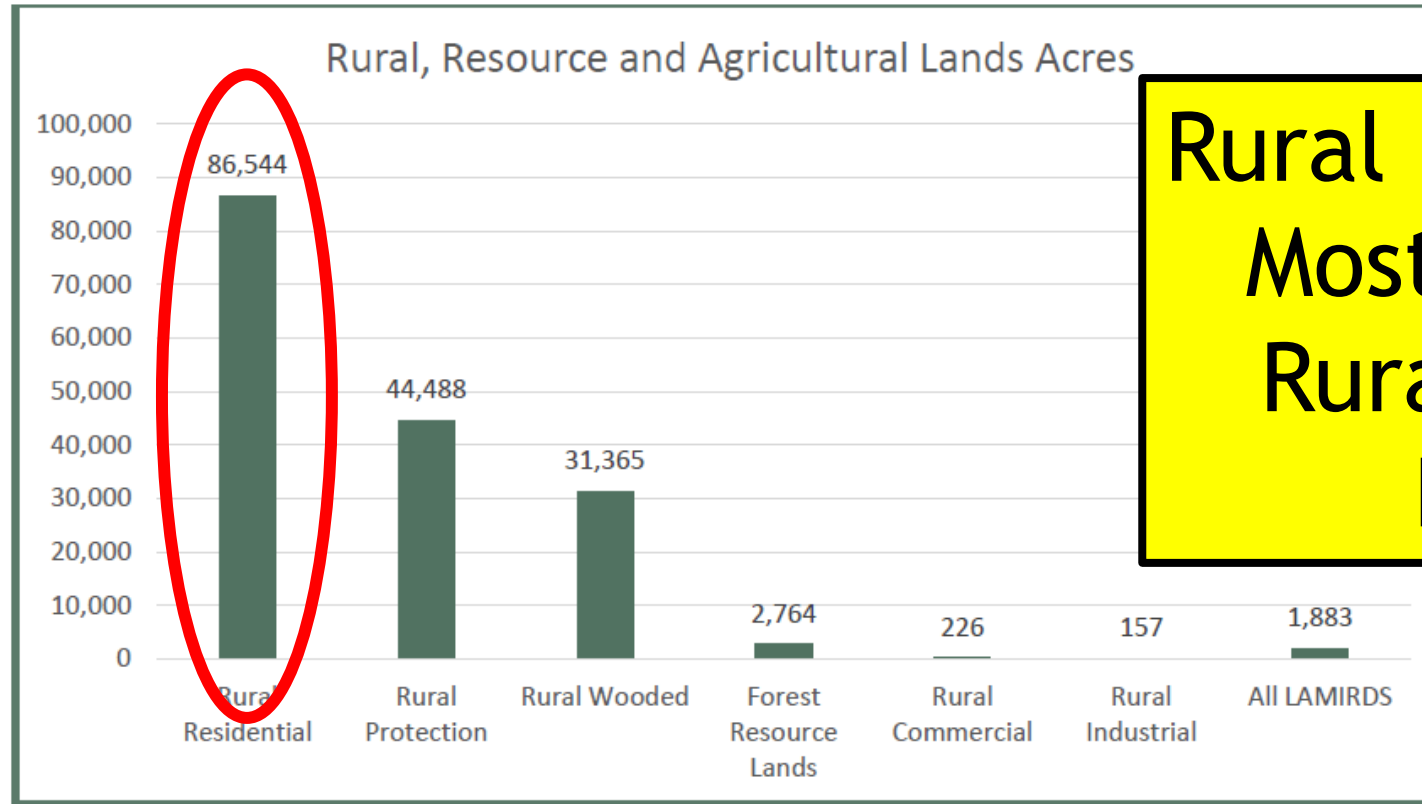

**Rural Residential:  
Most Common  
Rural Zone in  
Kitsap**

	Percent*	Acres
Rural Residential	34%	86,544
Rural Protection	12%	44,488
Rural Wooded	17%	31,365
Forest Resource Lands	1%	2,764
Rural Commercial	<< 1%	226
Rural Industrial	<< 1%	157
All LAMIRDS**	< 1%	1,883
		167,427

- ▶ No Rezone Needed for Sports, Recreation, Trails & Open Space

- ▶ Rezone is only needed for:

  - ▶ Restaurant

  - ▶ Increased Density

- ▶ Raydient's Goal:

  - ▶ Realize enough economic benefit to transfer 100-200 acres of land to the public at little or no cost

  - ▶ Compensation for land and planning expense is increased density, not cash

  - ▶ Density increase - 20 to 80 single-family lots (a 60-lot increase)

# More Information:

\*Website - [www.northkitsapunited.com](http://www.northkitsapunited.com)

\*Frequently Asked Questions (FAQ's for each organization)

\*UGA/GMA Whitepaper & Feedback Cards- Back Table

\*Social Media Updates - Public Meetings

Kingston-NK  
**Rotary**  
Club

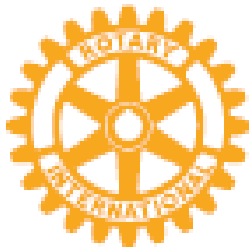

# Next Public Meeting & Update:

Tuesday, December 12<sup>th</sup> - 6pm

NK Auditorium - Poulsbo

Kingston-NK  
**Rotary**  
Club

